

- High temperature cups with a vulcanized felt
- Non marking technology
- Temperature rating up to 550°C (1022°F)
- Used for glass, ceramic, steel and plastics handling
- Cups include rubber body and high temperature foam seal

HT	20		NR	
Series	Model	Diameter	Cup Rubber Material	
	25	25	NR	NBR Rubber
	37	37	FKM	Fluorocarbon
	57	57	SS	Silicone
	70	70		

*Part number example
HT20FKM 25mm Diameter
Cup in Fluorocarbon Rubber*

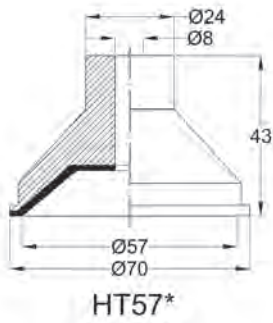
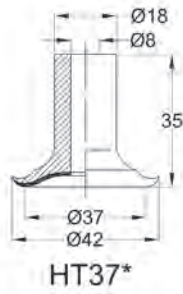
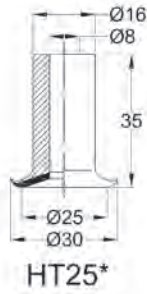
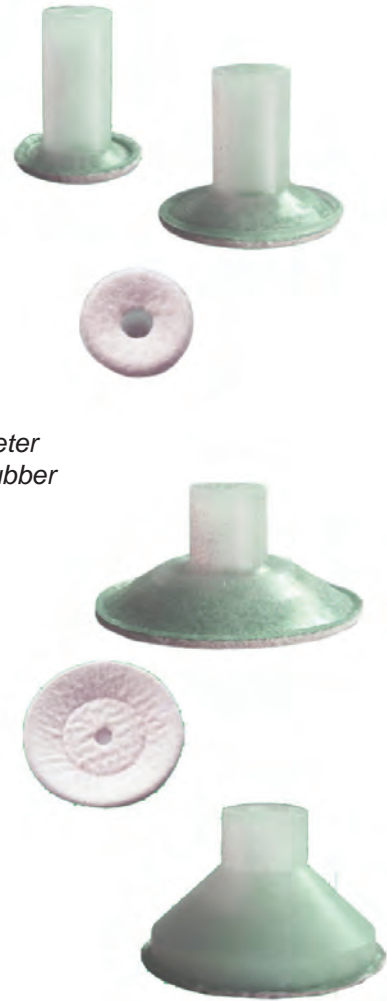

* indicates cup material choice

Maximum Temperature Rating	
NBR Rubber	100°C (212°F)
Silicone	350°C (660°F)
Fluorocarbon	550°C (1022°F)

Maximum temperature ratings are based upon duration of hold time, the time between cycles and vacuum level being used. Trials should be administered for longer contact periods.

HT CUP FITTINGS

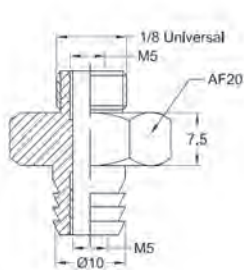

Model
VFCFB10-U01

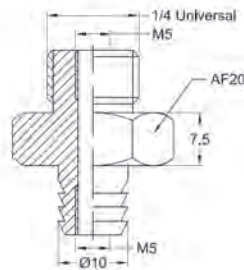

Model
VFCFB10-U02

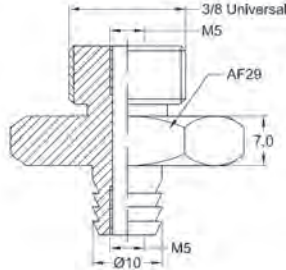

Model
VFCFB10-U03

HT HIGH TEMPERATURE CUPS



- High temperature cups with vulcanized felt
- Non marking technology
- Temperature rating up to 550°C (1022°F)
- Used for glass, ceramics, steel and plastics handling
- Cups include rubber body and high temperature foam seal



HT		90		NR	
Series	Model	Diameter	Cup Rubber Material		
	90	90	NR	NBR Rubber	
	120	120	FKM	Fluorocarbon	
	160	160	SS	Silicone	

The illustrations below show the dimensions of the cup on the left with the corresponding fitting assembly on the right. The cups and the fittings should be ordered separately. The cup fitting is a three piece fixture that clamps the cup to ensure a rigid assembly.

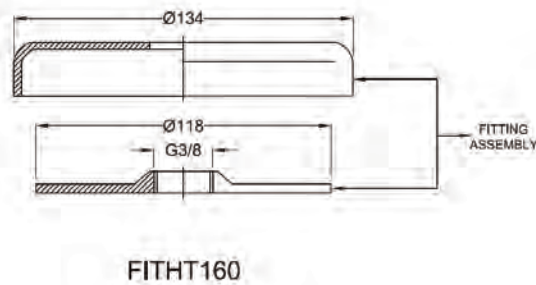
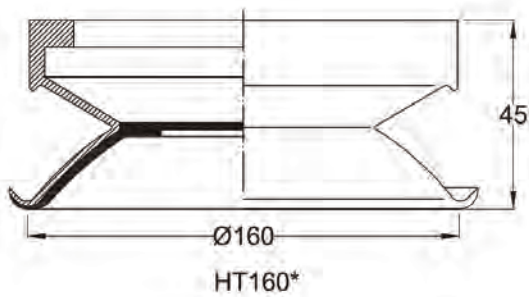
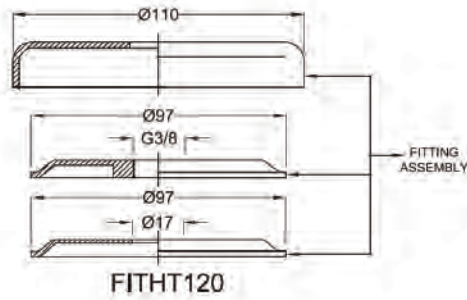
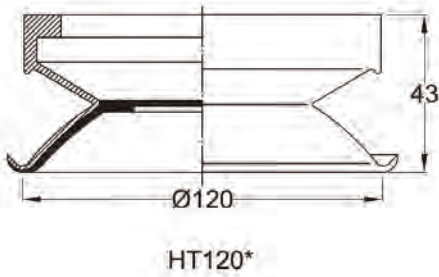
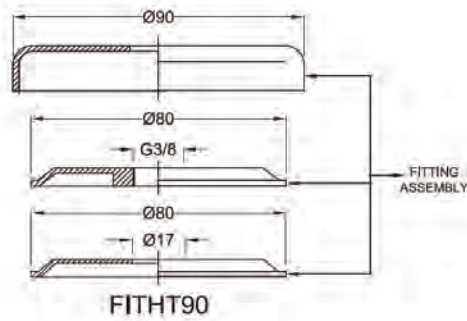
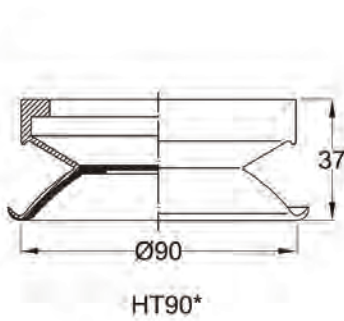

* indicates cup material choice

- High temperature cups with vulcanized felt
- Non marking technology
- Temperature rating up to 550°C (1022°F)
- Used for glass, ceramics, steel and plastics handling
- Cups include rubber body and high temperature foam seal

HT	190		NR	
Series	Model	Diameter	Cup Rubber Material	
	190	190	NR	NBR Rubber
	250	250	FKM	Fluorocarbon
	310	310	SS	Silicone



The HT190 Series is assembled onto the applicable fitting as shown in the HT190 table below. The HT250 and HT310 cup assemblies do not have a vacuum port or mounting hole(s). These features are installed by the user. Cups and fittings should be ordered separately.

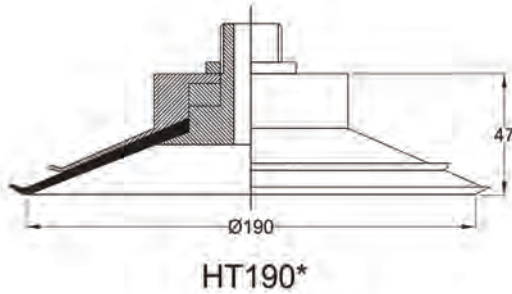

HT190 Cup Fittings	
FITHT1901/2	G1/2
FITHT1903/4	G3/4

The HT190 cup is shown assembled on the corresponding cup fitting. There are two types of fitting as shown in the table above.

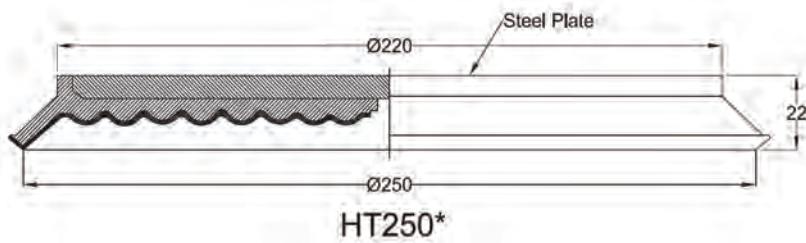

HT250 Cup Fitting
FITHT250

The HT250 cup fitting is supplied without mounting or vacuum ports.

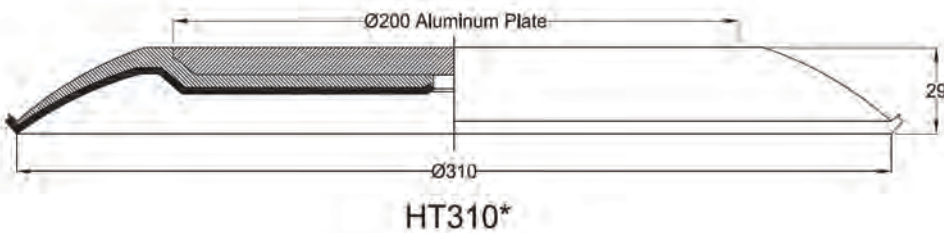

HT310 Cup Fitting
FITHT310

The HT310 cup fitting is supplied without mounting or vacuum ports.

* indicates cup material choice